

RSB3 Low Profile Load Cell With Threaded Stud

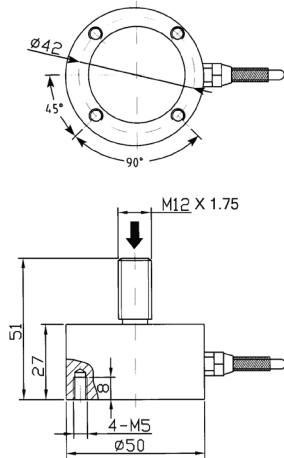

Accuracy Specifications

Accuracy	
Non-linearity	$\pm 0.1\%$ Full Scale
Hysteresis	$\pm 0.5\%$ Full Scale
Non-repeatability	$\pm 0.5\%$ Full Scale

Load Cell Specifications

Zero Balance	$\pm 2\%$
Safe Overload	to 120% of capacity (300% Ultimate Overload)
Rated Excitation	10V DC (15V Maximum)
Full Scale Output	1.5 mv/V
Connections	1m Cable
Input Impedance	$750 \pm 30 \text{ Ohm}$
Output Impedance	$700 \pm 4 \text{ Ohm}$
Insulation	$> 2,000 \text{ M}\Omega$
Creep, in 30 min	$\pm 0.05\%$ of Load
Operating Temperature Range	-20°C to 60°C with TARE
Temperature Effect on Output	0.05% of Full Scale/ 10°C
Temperature Effect on Zero	0.05% of Full Scale/ 10°C
Seal Type	IP66

Compatible Accessories

Recommended Interfaces



DI-100U/DI-1000U
Digital Load Cell Interface



DI-1000Z
Wireless Load Cell Interface



AI-1000
Signal Conditioner



RD-1000
Resistive Load Cell
Display



RE-M12-F
Rod End



TX-RSB3
Tension Adapter

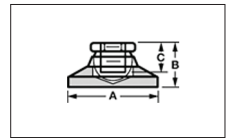

LF-M12-F
Self Leveling Foot

Wiring Information

Cable Color Code	
Red	+ Excitation
Black	- Excitation
Green	+ Signal
White	- Signal

Ordering Information

Multiple Load Cell Capacities	
RSB3	Part No.
50 kilogram	RSB3-050M-S
100 kilogram	RSB3-100M-S
200 kilogram	RSB3-200M-S
500 kilogram	RSB3-500M-S

Calibration Options

*C01	Compression
*C02	Tension
*C03	Universal

Wireless Load Cell Configuration



USB Load Cell Configuration

