

# Driver Specification Sheet

Model No.: SLS-250S38CP00-04

Product Line: Tymphany

Rev: 1

Last Update: 2017-03-03 09:00:02

## Product Description

SLS, woofer, 10inch, paper cone , steel basket,4ohm



## Mechanical Drawing

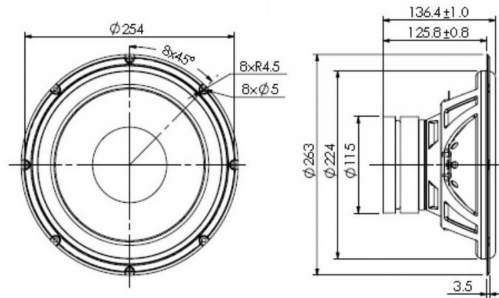

## Specifications

DC Resistance	Revc	Ohms	3.4	5.0%	Energy Bandwidth Product	EBP	(1/Qes)*fs	
Minimum Impedance	Zmin	Ohms	3.82	7.5%	Moving Mass	Mms	g	54.9
Voice Coil Inductance	Le	mH	0.69		Suspension Compliance	Cms	um/N	639
Resonant Frequency	Fs	Hz	26.9	15%	Effective Cone diameter	D	cm	21
Mechanical Q Factor	Qms		12.34		Effective Piston Area	Sd	cm^2	346.4
Electrical Q Factor	Qes	0.38			Effective Volume	Vas	L	108.45
Total Q Factor	Qts	0.37			Motor Force Factor	BL	Tm	9.06
Ratio Fs/Qts	F	Fs/Qts	72.12		Motor Efficiency Factor	β	(T*M^2)/Ohms	24.1
Half Space Sensitivity @2.83V	db@2.83V/1M	dB	92.1	+/- 1.0db	Voice coil former Material	VCfm		
Half Space Sensitivity @1W/1M	db@1W/1M	dB	88.9	+/- 1.0db	Voice coil inner diameter	VCd	mm	38.46
Gap Height	Gh	mm	8		Rated Noise Power	P	W	80
Maximum Linear Excursion	Xmax	mm	4.6		Test Spectrum Bandwidth		20Hz-20KHz	
Ferrofluid Type	FF				Driver Size	Inch	10 in	
Driver Mass	Kg	3.16						

## Frequency and Impedance Response

