

THIS DRAWING IS UNPUBLISHED. RELEASED FOR PUBLICATION 20  
 © COPYRIGHT 20 BY - ALL RIGHTS RESERVED.

REVISIONS				
P	LTR	DESCRIPTION	DATE	APVD
	A	RELEASED	11APR2018	KM DW

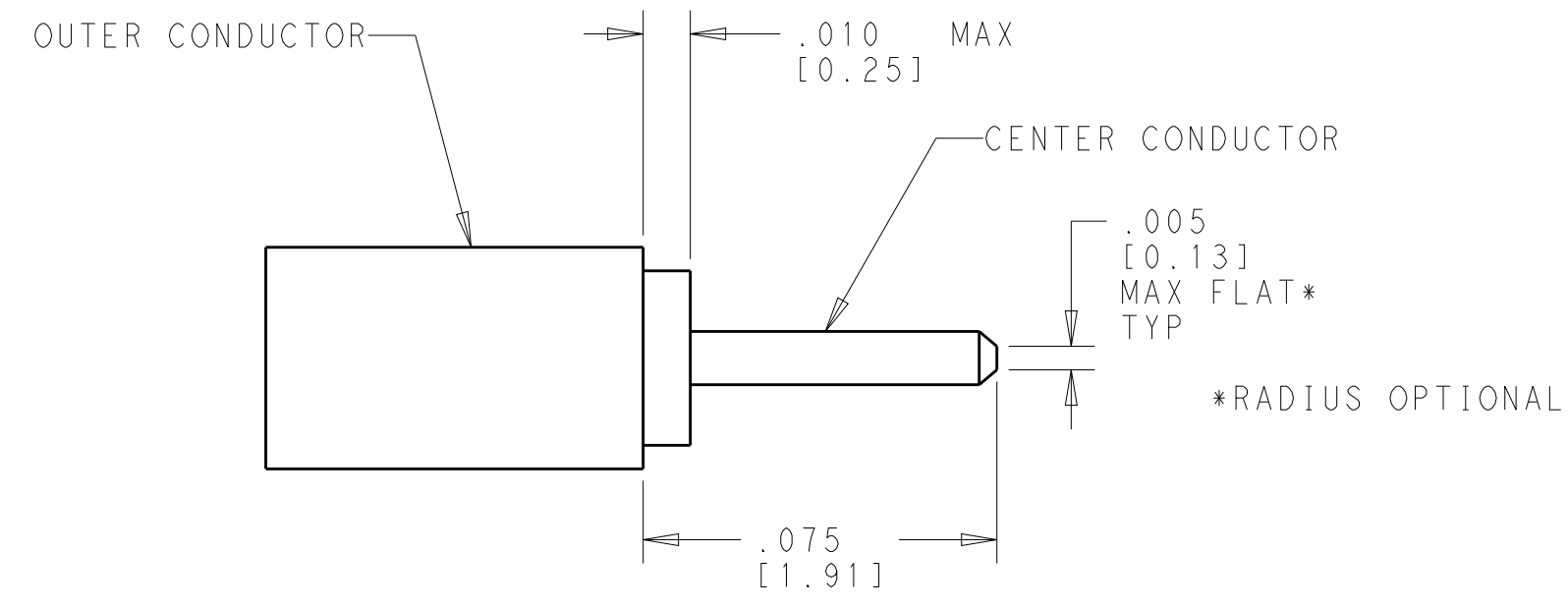
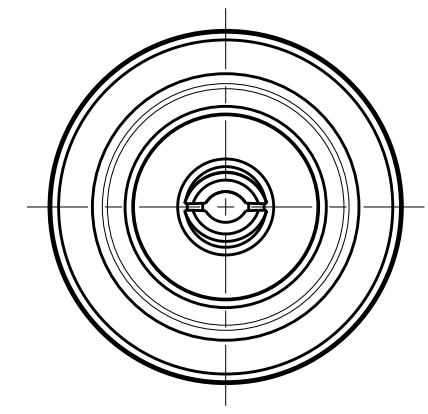
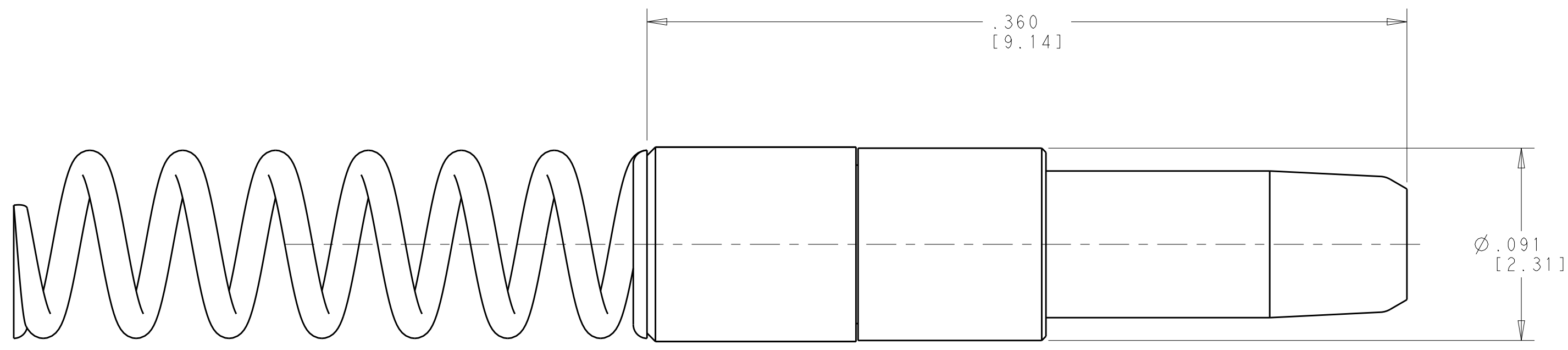

- 1 MATERIAL:  
 BODY AND CENTER CONTACT: COPPER ALLOY  
 INSULATOR: TEFLON (PTFE)  
 SPRING: STAINLESS STEEL
- 2 FINISH: FRONT BODY AND CENTER CONTACT: 50-90 μIN GOLD PLATE OVER NICKEL  
 REAR BODY: 3-15 μIN GOLD PLATE OVER NICKEL
- 3. SPRING IS SHIPPED LOOSE FROM CONTACT ASSEMBLY

SCALE 25:1  
 CABLE PREPARATION FOR  
 Ø.047 SEMI-RIGID CABLES

2302345-1  
 PART NO.

THIS DRAWING IS A CONTROLLED DOCUMENT.		DWN K. MILLER 31MAY2016	<b>STE</b> TE Connectivity	
DIMENSIONS: INCHES [mm]		CHK D. WILSON 31MAY2016		
TOLERANCES UNLESS OTHERWISE SPECIFIED:		APVD D. WILSON 11APR2018	NAME NanoRF PIN CONTACT ASSEMBLY	
0 PLC ± 1 PLC ± 2 PLC ± 3 PLC ±.005(0.13) 4 PLC ±		PRODUCT SPEC 108-163006	SIZE A200779	
MATERIAL 1		APPLICATION SPEC 408-163016	CAGE CODE C-2302345	DRAWING NO -
FINISH 2		WEIGHT -	RESTRICTED TO -	SCALE 20:1 SHEET 1 OF 1 REV A
CUSTOMER DRAWING				